

TRANSCRIPTION OF GRAVES IN THE CHURCHYARD OF ST MARY'S, STOWE

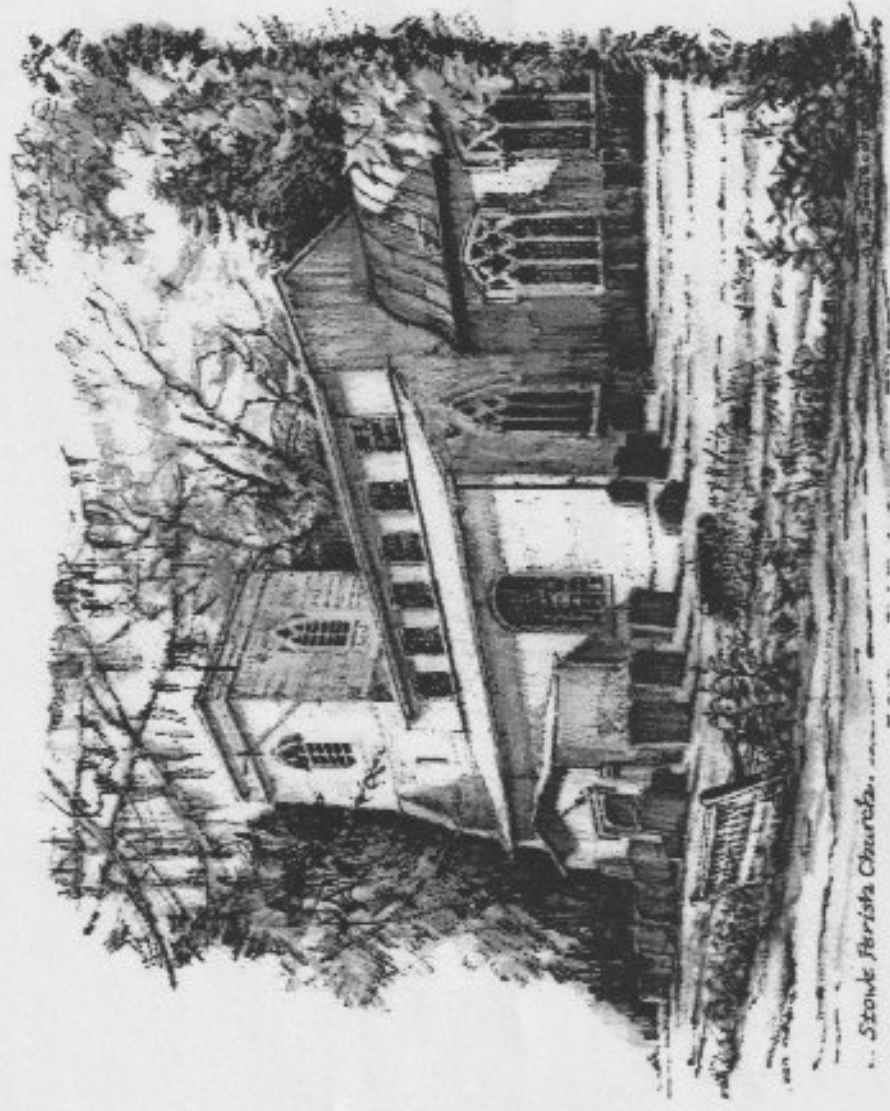

Stowe Peristyle Church.

Transcribing undertaken by Chris and Philippa Atkinson in 2014-15

Updated July 2018 by Jack Ryley

Cover illustration by Guy St John Scott

Whilst every care has been taken to achieve accuracy, there will always be errors in the process of transcribing due to the age and fragility of the stones. Checks were made with the Burial Registers in the Local Studies Centre, Aylesbury and in some cases information from these records, indicated by square brackets, has been included in the entries.

Dots represent illegible words or letters and oblique marks indicate line breaks.

INDEX

Graveyard Areas

Register of Gravestones

Index in Alphabetic Order

Index in Date order

AREA 1

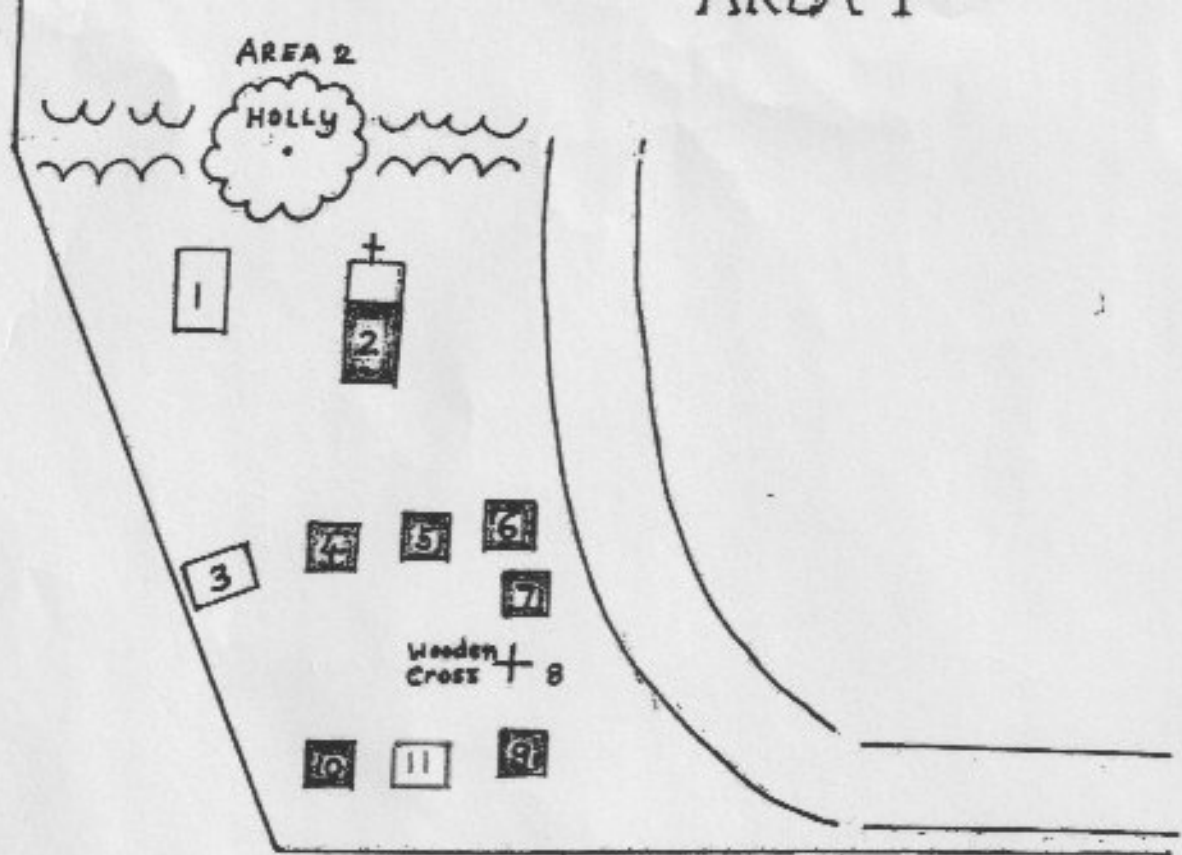

0 1 2 3 4
1 cm : 1 metre.

AREA 2

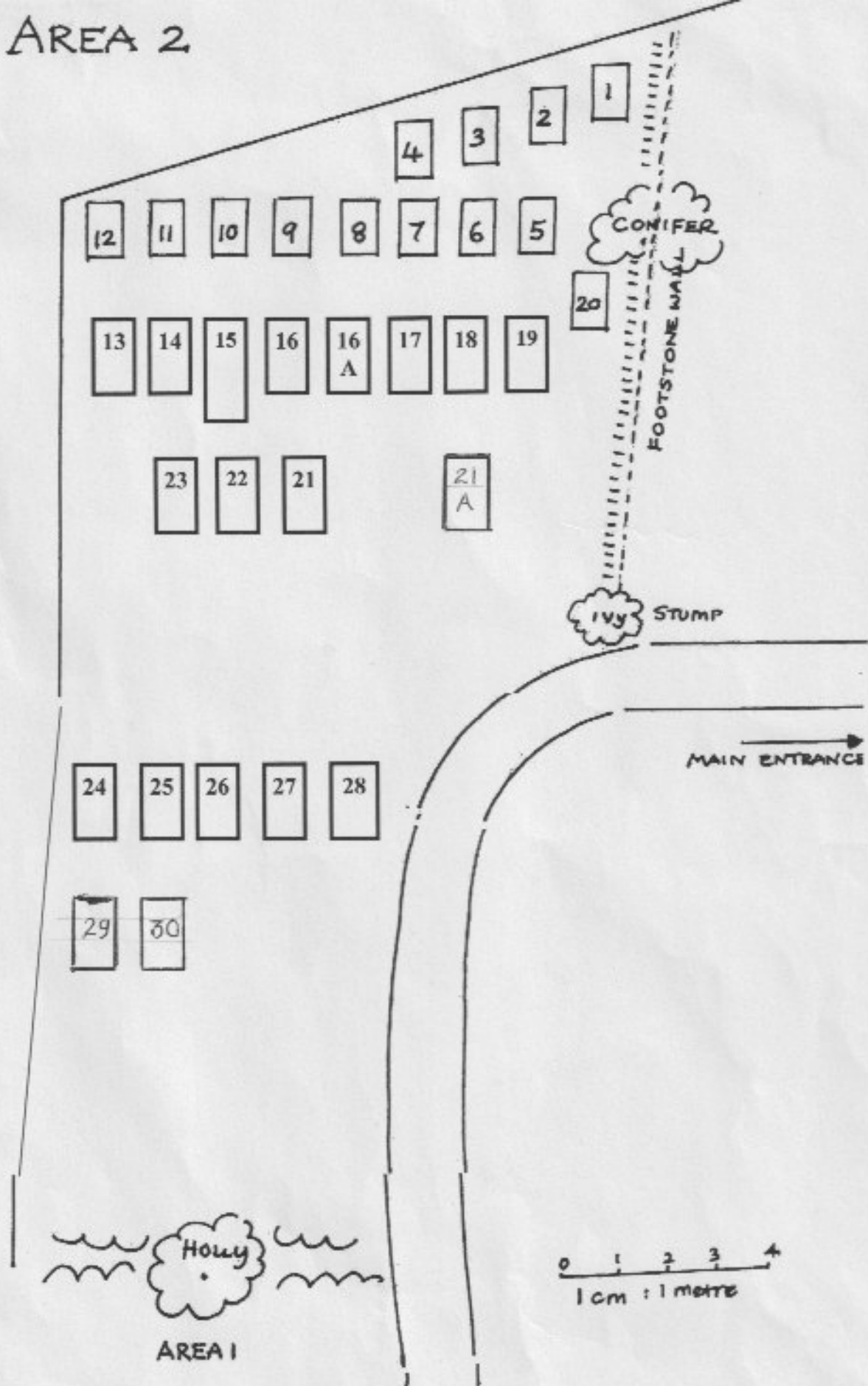

IVY STUMP

MAIN
ENTRANCE

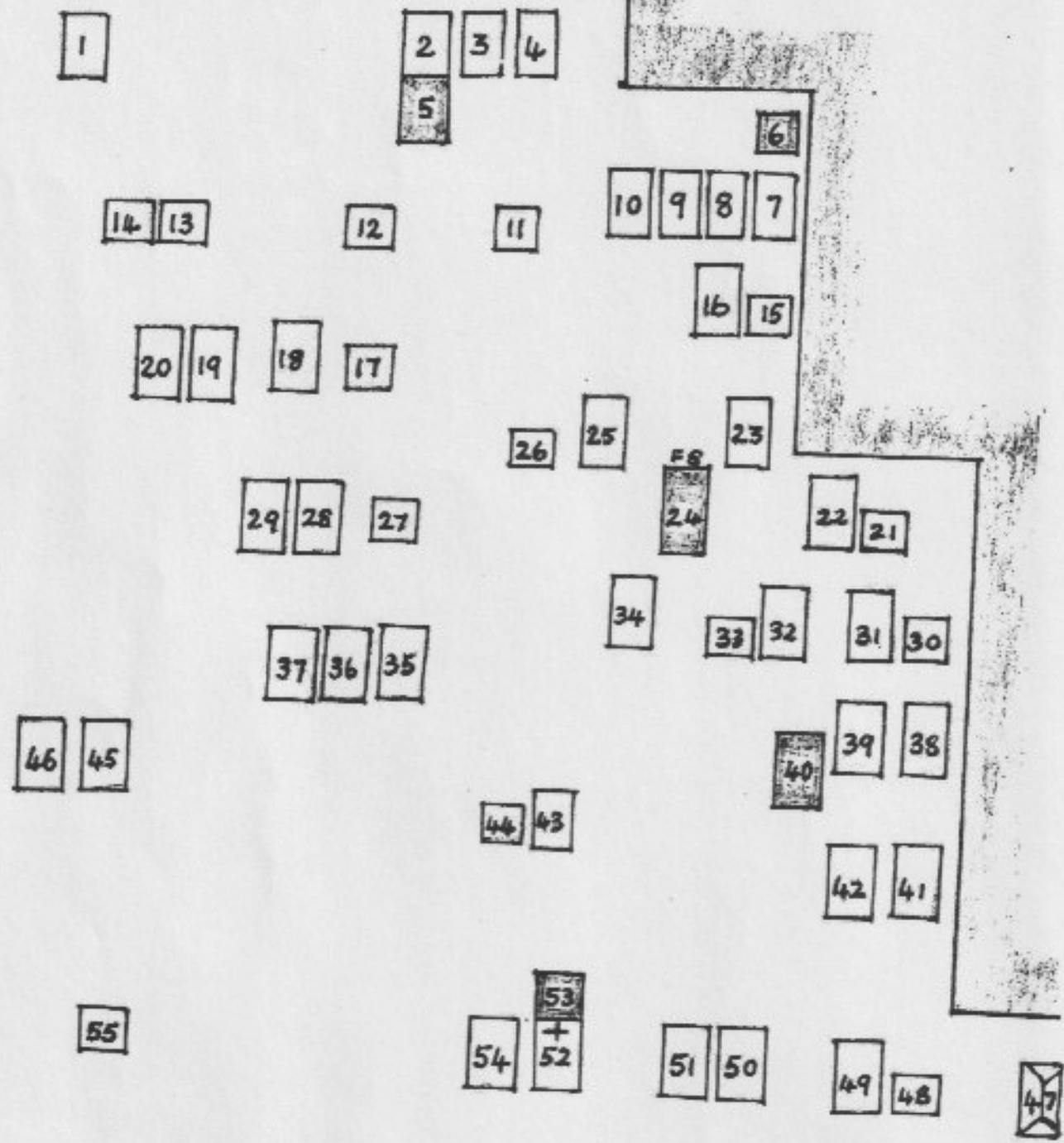

0 1 2 3 4
1 cm : 1 metre

AREA 5A

PATH

REAR DOOR

on wall

2

3

4

1

5

6

7

8

9

12

15

14

11

10

13

16

19

18

17

0 1 2 3 4

1cm : 1metre



AREA 5B

34

33

32

30

31

AREA 4

2
1

29

28

27

26

25

24

23

22

21
20

TERRACE

Tree
stump



0 1 2 3 4
1 cm : 1 metre